

DIRECT SERIES LIGHTING CONTROL MODULE



DR-KP0606

CONTROL KEYPAD

DR-KP0606 is designed for type 86 box installation and matches perfectly with popular faceplates. Each of the six programmable keypad buttons has its status indicated through an LED. Reset-mode touch switch is utilized to realize stable performance of the entire unit. Finished in tempered glass, the keypad provides two IO input channels for connection of sensors.

FEATURES

- 6 custom-engravable keypad buttons.
- Programmable for tap, double-tap, and press and hold.
- 2 sense circuits with 24V power supply.
- Sense interface uses opto-isolator circuit and is protected from high voltage and overcurrent.
- Designed for Type 86 box installation and supports cascade connection of multiple faceplates.
- Tempered glass finish with customizable color options.

SPECIFICATIONS

Keypad buttons	6 single-action pushbuttons
Finish	Black tempered glass, other color customizable
Feedback LED	6 green LED feedback indicators
Sensor interface	2 × contact closure (on-off signal)
Switch mode	Reset-mode touch switch
Communication interface	1 × DR-Link
Power supply	DC24V 20 mA
Operation temperature / RH	0°C - 45°C / 20% - 93% RH
Storage temperature / RH	-40°C - +55°C / 10% - 93% RH
Dimensions (L x W x H)	90 mm × 90 mm × 22 mm
Weight	127 g/pcs

DIMENSIONS

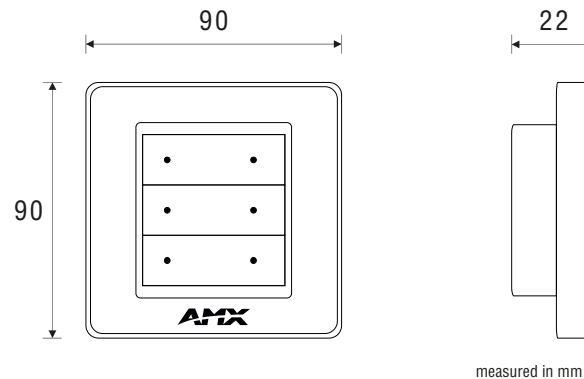

WIRING OF SINGLE MODULE

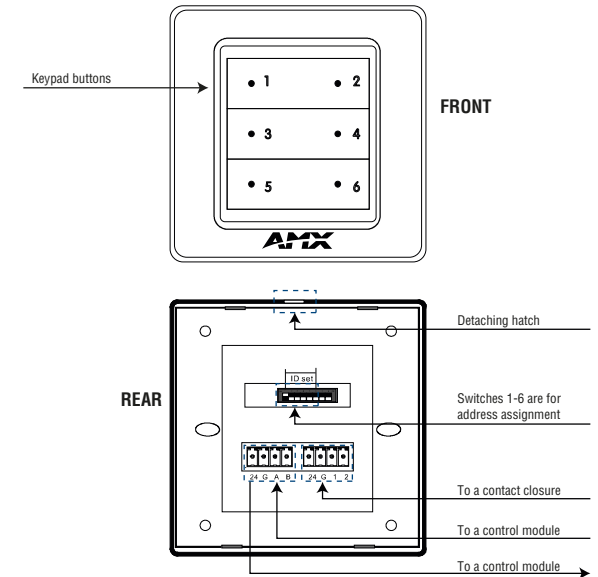

READE BEFORE USE

- Read this document carefully before use.
- Ensure the product is well ventilated.
- Avoid moisture, vibration and dust.
- Do not expose the product to rain, any types of liquid or corrosive gases.
- Dry the product immediately if it's affected by damp or splash.
- Refer all servicing to qualified service personnel or AMX if a product fault appears.

CONTACT

© 2017 Harman. All rights reserved. ENZO, NetLinX, AMX, AV FOR AN IT WORLD, HARMAN, and their respective logos are registered trademarks of HARMAN. Oracle, Java and any other company or brand name referenced may be trademarks/registered trademarks of their respective companies.

AMX does not assume responsibility for errors or omissions. AMX also reserves the right to alter specifications without prior notice at any time.

The AMX Warranty and Return Policy and related documents can be viewed/downloaded at www.amx.com.

3000 RESEARCH DRIVE, RICHARDSON, TX 75082

AMX.com | 800.222.0193 | 469.624.8000 | +1.469.624.7400 | fax 469.624.7153